

---

# Installation Instructions

## for 'The Inchworm' by Rain<sub>2</sub>O

---

Your Inchworm arrives with three elbows and one open-top box (A, B, C & D in the photograph below). They fit together as shown; elbow "A" slips into elbow "B." The "detail" photo shows the pre-crimped bottom end of "A" that makes it easy to slip one piece into another. Elbow "D" is already attached to Box "C."



Some people prefer the bottom edge of elbow B to be slightly above the top line of the collector, C, while other people prefer that the bottom edge of B ride below the edge of the collector, C; either way works.

Below on the left is a typical 55 gallon barrel with a white plastic cap screwed into the barrel's hole. If your barrel came with a cap, please remove it and set it aside. The bottom of your inchworm has a hole drilled through it and placed into that hole is a new cap (NPT or Buttress, depending on which you specified) through which a hole has been drilled. Screw this plastic cap into your rain barrel while trapping the bottom of the inchworm between the cap and barrel to form a tight fit. If you are having difficulty, grasp the collector box by its elbow with one hand and hold the opposite edge of the barrel with your other hand and – while turning the elbow – walk around the barrel. The drilled-out cap should be snug in the hole but it is better to under-tighten than over-tighten.



Many rain barrels have two openings. Make sure that the other opening is capped tightly – otherwise, when your rain barrel fills up, rain water will spill out of that opening instead of backing-up into the *Inchworm* downspout diverter and spilling into your lower downspout.

Once assembled, place your rain barrel with Inchworm next to your existing downspout. Don't forget to place it on a stand if you plan to use one. Mark and cut your existing downspout as shown below. A hacksaw can be used to cut downspout. Make sure you wear thick gloves to protect your hands and wear protective eyewear. If you are not an experienced carpenter or you are not in good health, please hire a professional installer to install your inchworm.

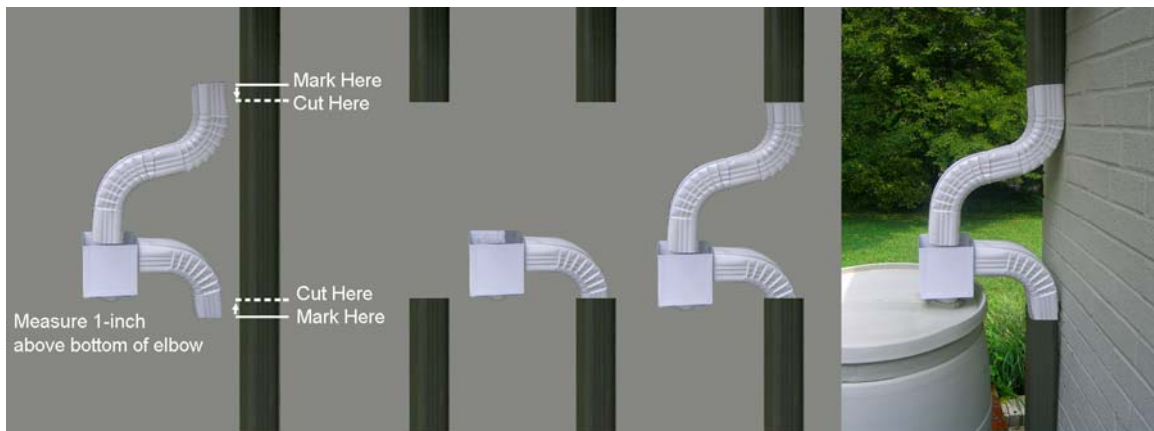

The lower elbow should slide into the lower portion of your downspout; the upper elbow should slide over the sides of the upper portion of your downspout.

During winter months you can either remove the inchworm altogether and slide back into place the old section of downspout that you removed earlier or you can remove the collector box and replace it with an elbow. Bear in mind that our white aluminum Inchworm diverters use 90° elbows, not the 75° elbow commonly found in stores. An additional 90° white elbow can be purchased from Rain<sub>2</sub>0.com. Our brown Inchworms use 75° elbows which you can more readily find in stores or buy from us.

These instructions assume that you would like to place your rain barrel in front of your downspout. Raising your rain barrel on a stand makes placement especially easy because a raised rain barrel does not block the typical front-facing elbow (called an “A” elbow) found at the bottom of most downspouts, assuming the stand being used is open in front and back. If you are not raising your rain barrel or the stand that you are using does not have an open front and back, you can replace your “A” elbow with a “B” elbow that discharges to the side rather than to the front. You can pick up a “B” elbow from most home improvement stores or purchase one from Rain<sub>2</sub>0.com.

If you would like to place your rain barrel to the left or right of your downspout, you will need two pairs of “B” elbows which you can purchase either from your home improvement store or from Rain<sub>2</sub>0.com.

That's it! If you have any questions, please contact us at (888) 673-6724 or [support@rain2o.com](mailto:support@rain2o.com) or visit us on the web at [www.rain2o.com](http://www.rain2o.com).